

HEIGHT (51'2", 81'8" and 112'2")

3. OPENING THE JIB

3. 1. " Travelling forward "

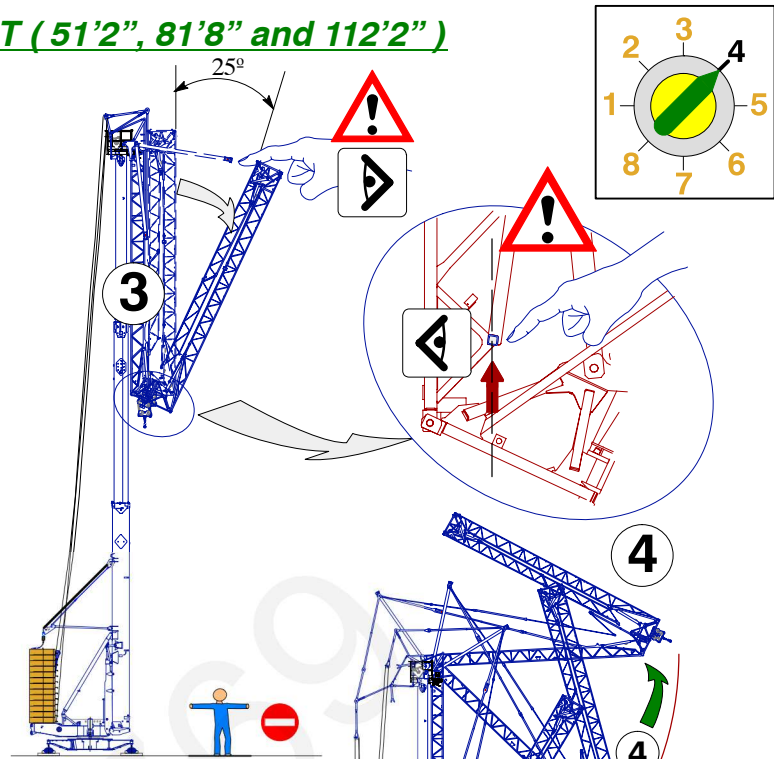
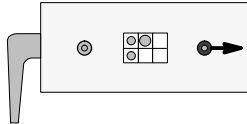

4. RAISING THE JIB

4. 1. " Trolley in "

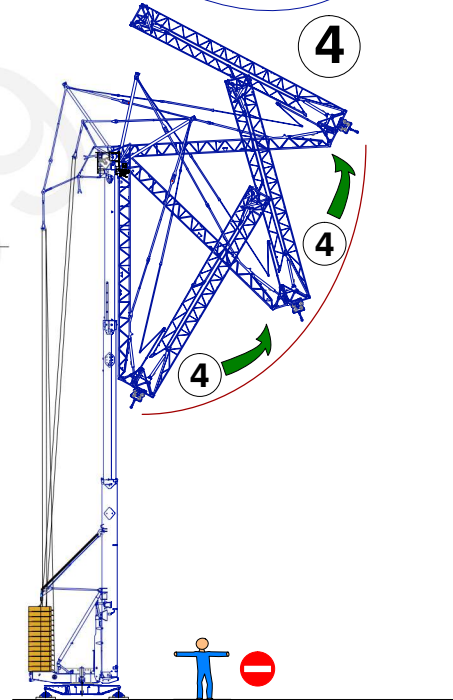
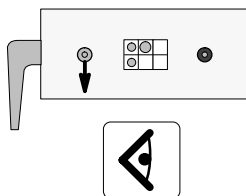

5. LOCKING THE JIB RETAINING WINCH

5. 1. Put the pinning hole of the drum facing the notch

5. 2. Unlock the tensioner and pin it to the drum. Fix the safety pin (1).

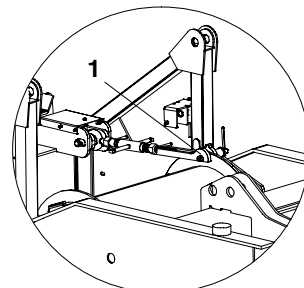
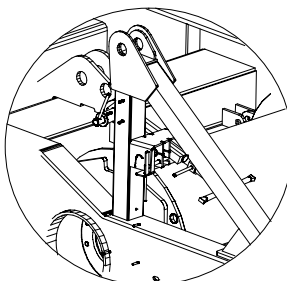
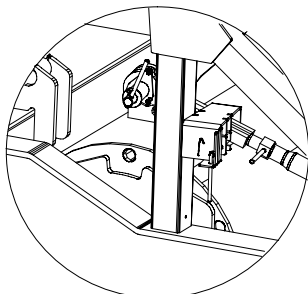

6. 2. Tighten the tensioner, a horn sounds. Continue tightening 0,5 to 1 turn. Lock the tensioner by means of the nuts (2).

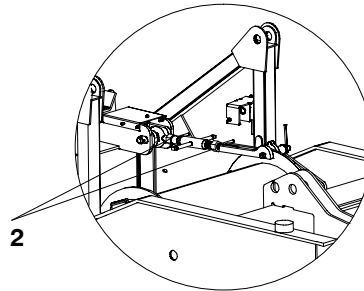
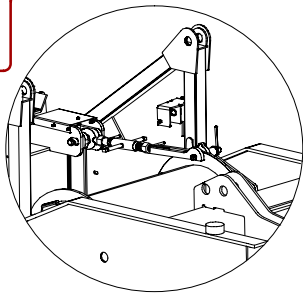

6. UNFOLDING THE JIB (Position 1 – 2 – 3)

6. 1. “ Travelling forward ”

